



### Spring Retractable Pre-Rinse Reels - 3/8" I.D.

Crafted for use with corrosion-resistant appliances in restaurants, institutions, home and garden applications, Reelcraft's pre-rinse reels include a standard lever-operated spray valve and stainless steel spring hose guard. Available in stainless or powder finish. Rated for hot water up to 210° F (99° C).

### Hot water washdown and food prep

Commercial use, restaurants, schools, home/garden and more

#### PRE-RINSE REEL FEATURES

- ✓ Lever-operated spray valve and stainless steel hose guard are included
- ✓ Optional 360° rotating swivel (600248) offers 20 degrees of angular motion
- ✓ Push-Lok, field replaceable, hose-end fittings
- ✓ Reels can be mounted on the wall, ceiling, or under a counter, making water conveniently available
- ✓ Latching mechanism hold hoses at desired length



A5835 OLBSW23

### Spring Retractable Potable (Drinking) Water Reel - 1/2" I.D.

Designed for potable water systems, the A5835 OLBSW23 is suitable for use as a drinking water system component. Fluid path is stainless steel and CPVC material.

### Drinking Water

Boats, RVs, buses and much more

Made in USA

#### POTABLE WATER REEL FEATURES

- ✓ Stainless steel, full flow shaft and swivel
- ✓ Convenient fast hook-up and disconnect
- ✓ Drain and standard female garden hose inlet fitting are standard
- ✓ Maximum operating temperature 86° F (30° C)

#### SPECIFICATIONS

MODEL	I.D.		O.D.		(F)NPTF INLET	LENGTH		WEIGHT		PRESSURE	
	in / mm	in / mm	in / mm	in / mm		ft / m	lbs / kg	psi / bar	psi / bar		
<b>PRE-RINSE REELS</b>											
4625 OLPSW5	3/8	10	.640	16	3/8	25	8	24	11	250	17
5635 OLPSW5	3/8	10	.640	16	3/8	35	11	30	14	250	17
5635 ELPSW5	3/8	10	.640	16	3/8	35	11	39	18	250	17
<b>PRE-RINSE STAINLESS STEEL REELS</b>											
5635 OLSSW5	3/8	10	.640	16	3/8	35	11	29	13	250	17
5635 ELSSW5	3/8	10	.640	16	3/8	35	11	39	18	250	17
<b>POTABLE (Drinking) WATER REELS OUTLET - Garden Hose Fitting 3/4" N/H Threads (F)</b>											
A5835 OLBSW23*	1/2	13	.781	20	1/2 Male	35	11	35	16	150	10

\* Maximum operating temperature is 86° F (30° C)

#### DIMENSIONS

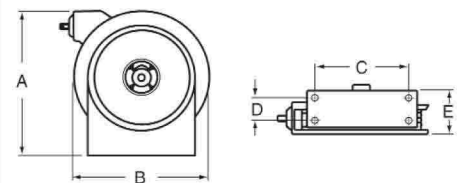

	4000 O		5000 O		5000 E	
	in / mm	in / mm	in / mm	in / mm	in / mm	in / mm
<b>A</b>	12 7/8	327	14 1/2	368	18 1/2	470
<b>B</b>	12 5/8	321	13 1/2	343	15	381
<b>C</b>	8	203	9 3/4	248	9 3/4	248
<b>D</b>	2 1/2	64	2 1/2	64	2 1/2	64
<b>E</b>	5 3/8	137	6	152	7	178

Four 5/16" (8mm) diameter mounting holes.